

# INSTALLATION SHEET

## CRAWL SPACE

WITH FOIL DOUBLE BUBBLE rFOIL™

- Reduces heat loss and keeps floors warmer
- Prevents condensation from causing mold and bacteria growth
- Prevents ground moisture from causing dry-rot
- Deters insects and rodents from nesting
- Excellent vapor and radon barrier

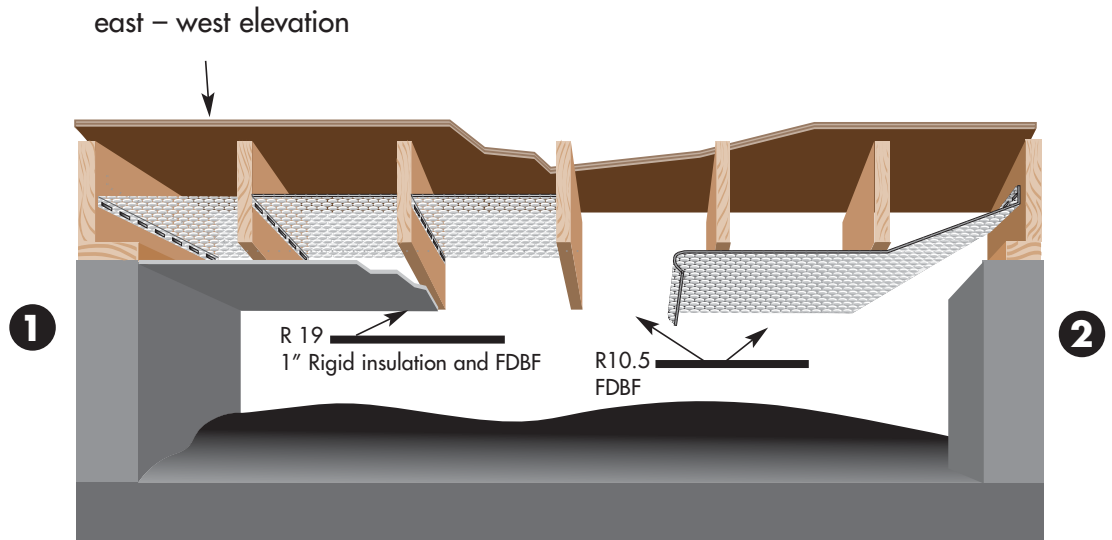

### INSTALLATION METHOD:

#### Method 1 - Between Joists:

- 1) Do not use fibrous insulation between your floor joists.
- 2) Using 16" wide rFOIL™ DOUBLE BUBBLE FOIL with Staple Tabs staple the material between the joists 2" - 4" below the sub-floor.
- 3) Seal ends with 3" wide rFOIL™ Regular FOIL Tape.

#### For Higher R-Value

**BUILDERS NOTES:** Nail the rigid insulation following the manufacturer's instructions. Make sure the air space between the rFOIL™ and the rigid insulation is well sealed.

#### Method 2 - Under Joists:

- 1) Staple rFOIL™ DOUBLE BUBBLE FOIL to the Ring Box joist.
- 2) Run the rFOIL™ along the underside of the joists, stapling to the joists every 4"-6".
- 3) Seal all of the seams with 3" wide rFOIL™ Regular FOIL Tape.

Suggested products to use in this application:

<b>Ultra rFOIL</b>	<b>• 1220-48-125 • 1222-16-125</b>
<b>rFOIL</b>	<b>• 2220-48-125 • 2222-16-125</b>
<b>Tape</b>	<b>• 15213</b>

\*All tape should be applied using a flat edge taping tool to ensure good adhesion.

\*\*Check local building codes for compliance before installation.\*\* These installation drawings are intended solely to illustrate the proper location and placement of rFOIL Insulation Products in specific construction applications. They are not intended to illustrate proper construction methods, which is ultimately the responsibility of the builder or contractor. The installation instructions are only recommendations relating to the location and installation method of rFOIL Insulation Products, and InsulationStop.com makes no claims that these construction systems are universally accurate. **IMPORTANT INFORMATION:** The information cited is in good faith and has been established from sources held to be secure and reliable. The values listed are typical properties and are not intended to be used as specifications for defined applications. User must determine the product suitability for the end use application and assume all risks and liabilities. 11/17/99

**INSULATION STOP .COM**  
RADIANT BARRIERS AND REFLECTIVE FOIL INSULATION

**rFOIL**  
Premium  
Insulation

www.insulationstop.com

(518) 867-9555

See specifications about our 10 year or 25 year warranties